

⚠ UNLOAD & MAKE WEAPON SAFE ⚠

1. Insert optic into ring.
2. Insert ring screws while applying minimal pressure to avoid cross-threading.
3. Visually level optic.
4. Progressively tighten screws in an alternating pattern, while pinching ring to prevent twisting of optic.

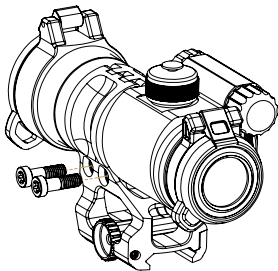

**MAX TORQUE 25 INCH-LBS**

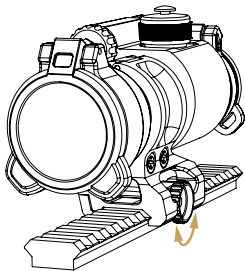

5. Open clamp no further than internal stops allow.
6. Hook Leap mount onto rail from ClickDrive side.
7. Close clamp by turning ClickDrive wheel as tightly as you can by hand (Do not use tools).

**PRO TIP USE YOUR RIGHT HAND TO TIGHTEN AND LEFT HAND TO LOOSEN**